



# KySTE 2018 Spring Conference

March 7-9, 2018 – Galt House Hotel  
Louisville, Kentucky

## EXHIBITOR INFORMATION

### APPLY ONLINE!

KYSTE 2018 expects over 1,600 in attendance and over 170 exhibit booths representing the following:

- technology products
- educational hardware
- educational software
- curriculum materials
- classroom and computer furniture
- distance learning products
- telecommunications providers
- professional development organizations
- textbook publishers
- audio visual products
- training
- mobile devices & apps
- other products and services that benefit the education community
- Security

If your organization wants to reach technology educators in Kentucky, KySTE is THE conference in which you need to participate!

### **About the Conference**

The Kentucky Society for Technology in Education (KYSTE) would like to invite you to exhibit at the 2018 KYSTE Conference. The conference and tradeshow will be held at the Galt House Hotel in Louisville, KY, March 7-9, 2018. Exhibits will be open on Wednesday and Thursday (7<sup>th</sup> & 8<sup>th</sup>) during the conference. The 2017 conference hosted nearly 1,700 attendees and 175 vendor booths.

Kentucky's premier education technology conference promotes the use of technology in Kentucky schools. The mission of KYSTE 2018 is to bring educators, administrators, technology professionals, college faculty and staff, public and academic librarians, business and industry trainers, industry representatives and policy makers together to think, discuss, listen and learn the best strategies to plan for, implement, and use education technology in our schools. This year's "theme" will be a "Mardi Gras" theme. Vendors are encouraged to theme their booths!

### **KYSTE Sponsor**

The KYSTE conference is sponsored and managed by The Kentucky Society for Technology in Education (KYSTE). KYSTE'S mission is to empower the educational community in the Commonwealth of Kentucky to infuse technology as an integral part of the educational process through advocacy and leadership, promoting educational excellence and supporting technology-based innovation. Please visit the KYSTE website for more information at [www.KYSTE.org](http://www.KYSTE.org).

### **Attendee Profile**

Nearly 1,700 K-12 and higher education, teachers, administrators, technology and media specialists, business leaders, legislators, and state and federal government agencies attended the 2017 conference. The exhibit hall is a highly-valued part of the conference. Ample time has been built into the 2018 conference schedule to allow attendees to visit the exhibit hall, including expanded hours during Wednesday's Grand Opening. Please contact Exhibit Management for more detailed attendee demographics from the 2017 conference ([kay@tmcshows.com](mailto:kay@tmcshows.com)).

### **Sponsorship Opportunities and Packages**

Sponsorships are a great way to gain added exposure for your company! See the online Sponsorship Application for more details on what each sponsorship level includes.

## [SPONSORSHIP APPLICATION](#)

## How to Reserve a Booth

Booth space will be assigned on a first-come, first-served basis. A floor plan and Application to Exhibit are enclosed. Please complete this application and make several booth selections from the floor plan, in case your first choice is unavailable. Be sure to indicate if there are any companies that you would prefer to be located apart from or located near. Every effort will be made to accommodate your booth preference. Complete the [online application form](http://www.tmcshows.com/KYSTE) at [www.tmcshows.com/KYSTE](http://www.tmcshows.com/KYSTE) to apply. You will receive an emailed confirmation of your booth location and payment receipt, along with other conference related information. Please be sure to include a valid email address on your application.

**[APPLY ONLINE!](#)**

### Note about Vendor Sessions:

Vendors are welcome to apply for sessions online. The application will be open in the summer of 2016. Session applications will be reviewed by the KySTE Board for content and relevance, and approval notices will be emailed to you if your session is approved. The deadline to apply is November 15.

**Sponsors** will be given preference for vendor sessions. Please see our Sponsorship Application for more information.

**[Sponsorship Application](#)**

## Booth Fees and Package

**In-line 10X10 Booth = \$800; Corner 10X10 Booth = \$900**

Each 10' x 10' booth package includes: one 6' draped table; two chairs; one-line exhibitor identification sign; 8' back-wall drapes and 3' side-rails; booth and aisle carpeting. **\*\*Please note that electrical service is not provided with the booth package.** Electrical service can be ordered separately on your booth application form. There is an additional \$100 fee for electrical service. **Note: Booths 1 through 27 in the hallway and Clements room are only 8' deep x 10' wide.** Hallway booth are considered "prime" locations, and are \$900 each (same as corner booths.)

## Vendor Sessions

Vendors are welcome to apply to give a presentation at KYSTE 2018. The application will be available online at [www.tmcshows.com/KYSTE/Exhibits/](http://www.tmcshows.com/KYSTE/Exhibits/) beginning in July 2017. The deadline to apply to present is November 1, 2017.

## Conference Hotel

The Galt House Hotel in downtown Louisville is the host hotel for KYSTE 2018. Ask for special KySTE reduced room rates when making reservations. Reservations may be made any time after July 20, 2017. Additional hotel information is available online at <http://tmcshows.com/clients/kyste-annual-spring-conference/kyste-hotel-information/>. Pricing is below

### RIVUE TOWER – Deluxe Rooms

\$142.00 – Single

\$152.00 – Double

\$162.00 – Triple

\$172.00 – Quad

### SUITE TOWER – Executive Suites

\$162.00 – Single

\$172.00 – Double

\$182.00 – Triple

\$192.00 – Quad

## Exhibitor Services & Exhibit Management

An Exhibitor's Services Manual will be posted online at <http://tmcshows.com/clients/kyste-annual-spring-conference/kyste-exhibitor-services/>

Please take time to look over the online manual carefully. It contains valuable information that you will need to know before the show, and it will save you time and money. If you have questions about exhibits, contact Kay Van Treese, Exhibit Manager at 850-385-3595 or [kay@tmcshows.com](mailto:kay@tmcshows.com).

## Exhibit Schedule

Wednesday, March 7<sup>th</sup>

8:00 am – 4:00 pm

*Exhibitor Move-In.*

4:00 pm – 6:00 pm

*Grand Opening Reception!  
In Exhibit Hall*

Thursday, March 8<sup>th</sup>

8:00 am 4:00 pm

*Exhibits Open to Attendees.  
Continental Breakfast in Hall  
starting at 7:00 am.*

After 4:00 pm

*Exhibitor Move-Out*

Friday, March 9<sup>th</sup>

**No Exhibit Hall**

Please do not begin dismantling your booth or moving before the hall closes on Thursday. This will allow for attendees to safely exit the exhibit hall before move-out begins. Early move-out takes away from the overall look of the show & distracts other vendors who may be talking to attendees near your booth. Thank you for being considerate. A \$500 fine will be enforced for early move-out.

## Deadline

You may reserve a booth any time, as long as the exhibit hall still has availability. Please note that the booths usually sell prior to the conference. Early reservations are encouraged to secure a good location. There is no printed program deadline, as the entire program is only available via the Conference Mobile App.

[Apply Online](#)

or

**you may print and return your completed application and check to:**  
**KYSTE c/o Total Meeting Concepts, Exhibit Manager**  
**P.O. Box 13986**  
**Tallahassee, FL 32317**  
**Phone: 850-385-3595**  
**Fax: 904-339-9450**

## Exhibit Hall Floor Plan

Please select your preferred booth location, as well as an alternate location, from the map below and list it on your Application to Exhibit. If your selections are not available the best available booth will be assigned for you.

You can view an updated floor plan and list of exhibitors online at [www.tmcshows.com/KYSTE/Exhibits/](http://www.tmcshows.com/KYSTE/Exhibits/)

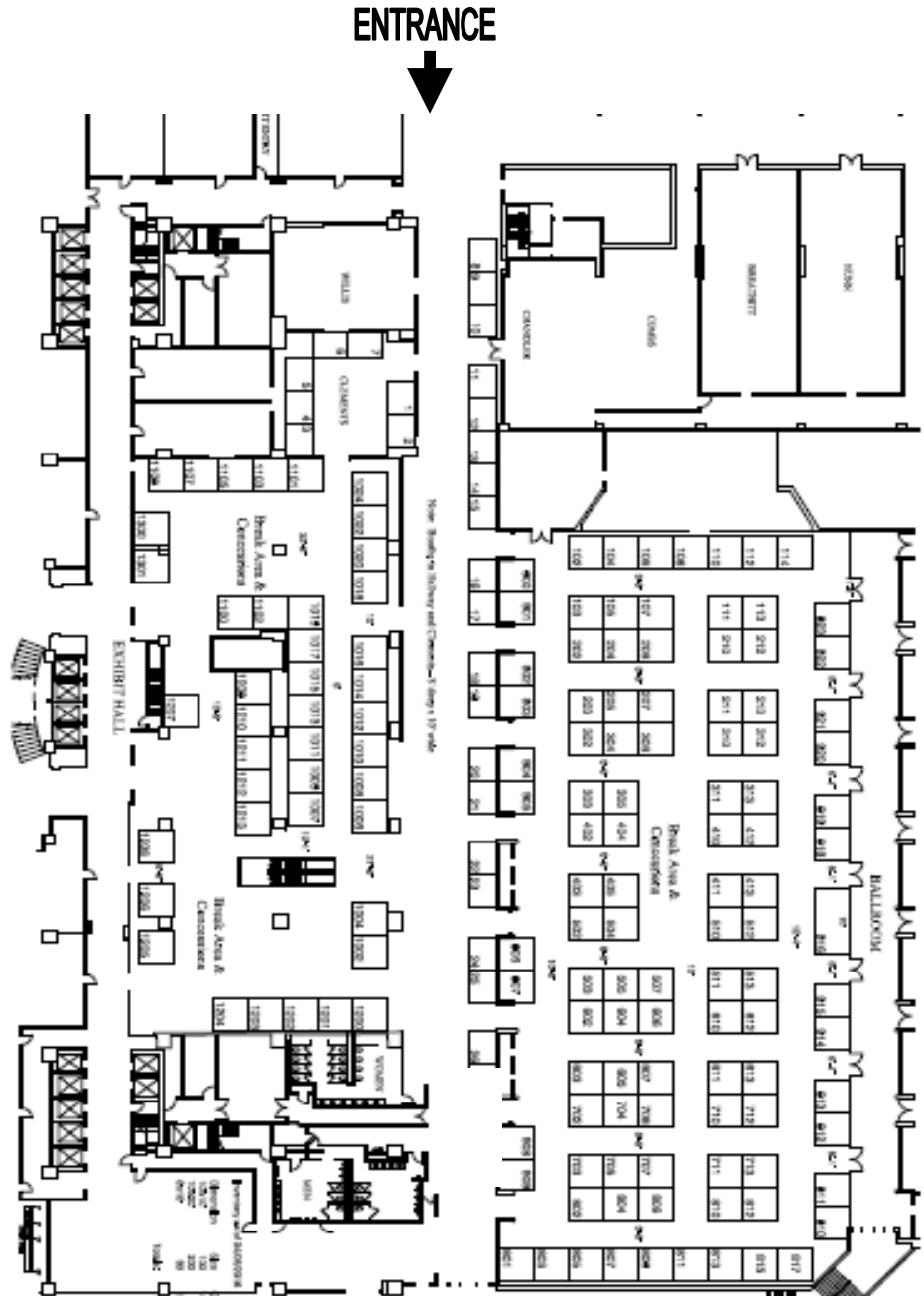

**APPLY ONLINE**

Please note that there are 3 separate exhibit areas (the Clements Room, Grand Ballroom and the Exhibit Hall). These exhibit areas are connected by an adjoining hallway. **Note: Booths 8 through 27 in the connecting hallway are only 8' deep x 10' wide.** These are considered prime locations and the booth fee is \$900 (the same as the corner 10'x10' booths inside the halls.)